

分
格
样
SIGN

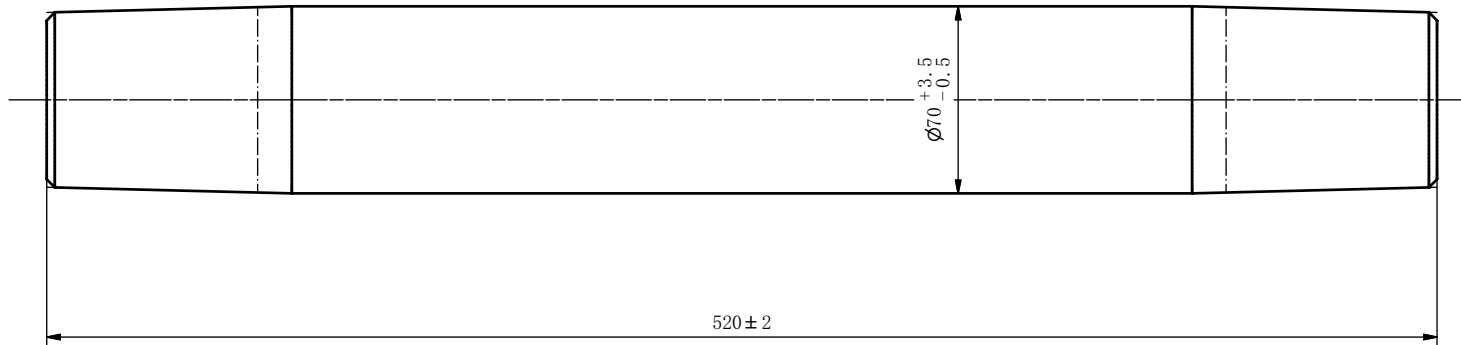

Technical Requirements:

- 1、 It is made of polymer composite materials,
and the materials should meet the corresponding standards;
- 2、 The compressive strength is not less than 600MP,
and the flexural strength is not less than 150MP;
- 3、 The withstand voltage is greater than 100KV,
and the breakdown voltage is not less than 120KV;
- 4、 Temperature resistance: 180° C;
- 5、 Straightness is not more than 1mm/m;
- 6、 When the cone surface is matched with the coupling,
the large end is in contact, and the contact surface is greater than 70%,
and the taper tolerance is controlled by a special gauge;
- 7、 Both ends allow to retain the center hole or retain the process boss,
length ≤ 4 .

本图及所含的技术信息, 为艾尼科环保技术(安徽)有限公司所有, 受法律保护,
事先未经本公司书面许可, 不得以任何方式抄袭、复制或用于其他工程。提供前披露给第三方。
THIS DRAWING AND THE TECHNICAL INFORMATION IT CONTAINS ARE THE PROPERTY OF EETC. IT MUST NOT BE
TRACED, COPIED, OR USED IN OTHER PROJECT NOR DISCLOSED TO ANY THIRD PARTY WITHOUT OUR WRITTEN CONSENT.